

SEAT

Designer: SPARK Tom Lauck



SLAT OPTIONS

- Oiled hardwood
- Composite
- Clear anodised aluminium
- Woodgrain aluminium

FRAME OPTIONS

- Hot dip galvanised mild steel
- 316 Stainless steel

FRAME FINISHES

- Hot dip galvanised
- Powdercoated
- Bead blasted, Electropolished

INSTALLATION

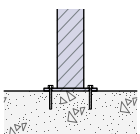

Bolt Down

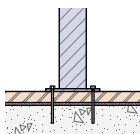

Bolt Through

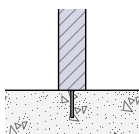

Concealed Fix

FIXINGS

- 12mm fixings for 14mm diameter holes

Alternative materials and finishes available on request

FOCUS SEAT

SPECIFICATIONS

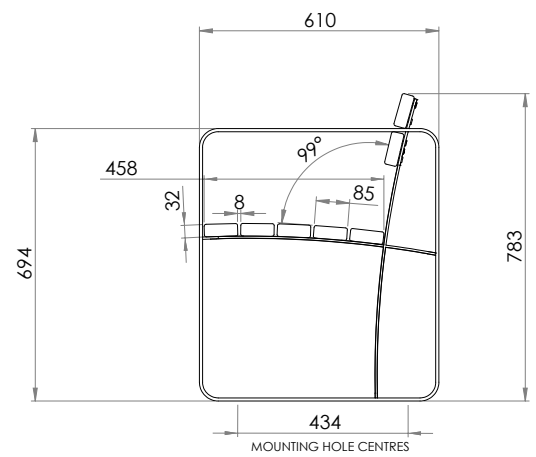
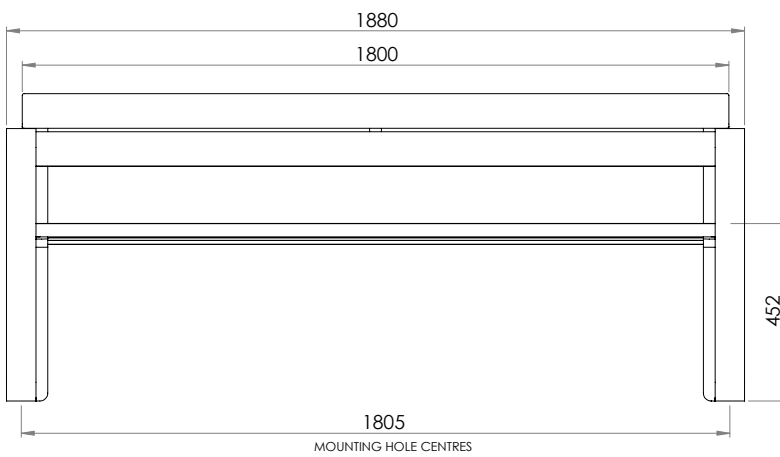
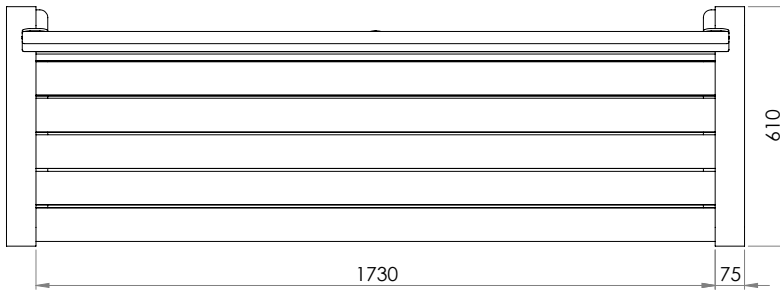

Measurements are in millimetres. Drawings are not to scale.
Batten dimensions shown are for timber slat option.

PRODUCT CODES	FRAME FINISHES	SLAT OPTIONS & SIZE (mm)
FOC003-HDG-GV-T	Hot dip galvanised	85x32 Oiled hardwood timber
FOC003-HDG-GV-C	Hot dip galvanised	90x40 Composite
FOC0030HDG-GV-A	Hot dip galvanised	90/65x35 Clear anodised aluminium
FOC003-HDG-GV-W	Hot dip galvanised	90/65x35 Woodgrain aluminium
FOC003-HDG-PC-T	Powdercoated	85x32 Oiled hardwood timber
FOC003-HDG-PC-C	Powdercoated	90x40 Composite
FOC0030HDG-PC-A	Powdercoated	90/65x35 Clear anodised aluminium
FOC003-HDG-PC-W	Powdercoated	90/65x35 Woodgrain aluminium
FOC003-S16-EB-T	Bead blasted, Electropolished	85x32 Oiled hardwood timber